

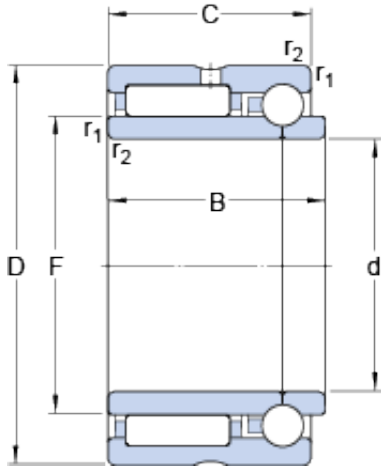

# PCIF BEARING LIMITED



12 mm x 24 mm x 17.5 mm skf nkib 5901 bearing

Bearing No. nkib 5901

nkib 5901 Bearing 2D drawings and 3D CAD models

Size	24x12x17.5 mm
Bore Diameter	24 mm
Outer Diameter	12 mm
Width	17,5 mm
d	12 mm
D	24 mm
B	17.5 mm
C	16 mm
F	16 mm
r <sub>1,2</sub> - min.	0.3 mm
d <sub>a</sub> - min.	14 mm
D <sub>a</sub> - max.	22 mm
r <sub>a</sub> - max.	0.3 mm
Basic dynamic load rating, radial direction - C	8.1 kN
Basic static load rating, radial direction - C <sub>0</sub>	9.6 kN
Basic dynamic load rating, axial direction - C	2.1 kN
Basic static load rating, axial direction - C <sub>0</sub>	1.9 kN
Fatigue load limit, radial direction - P <sub>u</sub>	1.1 kN
Fatigue load limit, axial direction - P <sub>u</sub>	0.083 kN
Reference speed	22000 r/min
Limiting speed	26000 r/min



## PCIF BEARING LIMITED

Category	Roller Bearings
Inventory	0.0
Manufacturer Name	SKF
Minimum Buy Quantity	N/A
Weight / Kilogram	0.037
EAN	7316577739933
Product Group	B04144
bore diameter:	12 mm
closure type:	Open
outside diameter:	24 mm
fillet radius:	0.3 mm
overall width:	17.5 mm
lubrication type:	Grease
bearing type:	Needle Roller/Angular Contact Ball
cage material:	Steel
operating temperature range:	Max 250 ° F
series:	NKIB
radial dynamic load capacity:	8.09 kN
manufacturer product page:	<a href="#">Click here</a>
radial static load capacity:	9.65 kN
manufacturer upc number:	7316577739933
bearing material:	Steel
weight:	0.095 lb
maximum rpm:	26000 rpm
r <sub>1,2</sub> min.	0.3 mm
d <sub>a</sub> min.	14 mm
D <sub>a</sub> max.	22 mm
r <sub>a</sub> max.	0.3 mm
Basic dynamic load rating, radial direction C	8.09 kN



## PCIF BEARING LIMITED

Basic static load rating, radial direction $C_0$	9.65 kN
Basic dynamic load rating, axial direction C	2.07 kN
Basic static load rating, axial direction $C_0$	1.92 kN
Fatigue load limit, radial direction $P_u$	1.14 kN
Fatigue load limit, axial direction $P_u$	0.083 kN
Mass bearing	0.043 kg