

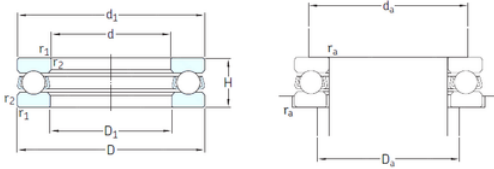

PCIF BEARING LIMITED

skf 51104 bearing



Bearing No. 51104

51104 Bearing 2D drawings and 3D CAD models

Size	20x35x10 mm
Bore Diameter	20 mm
Outer Diameter	35 mm
Width	10 mm
d	20 mm
D	35 mm
H	10 mm
d1	35 mm
r1 min.	0,3 mm
r2 min.	0,3 mm
D1	21 mm
da min.	29 mm
Da max.	26 mm
ra max.	0,3 mm
Weight	0,037 Kg
Basic dynamic load rating (C)	15,1 kN
Basic static load rating (C0)	29 kN
Fatigue load limit (Pu)	1,08
Reference speed	7500 r/min
Limiting speed	10000 r/min
Category	Thrust Ball Bearing
Inventory	6.0
Manufacturer Name	SKF
Minimum Buy Quantity	N/A
Weight / Kilogram	0.043
EAN	7316577058652



PCIF BEARING LIMITED

Product Group	B00308
Rolling Element	Ball Bearing
Thrust Bearing	Yes
Single or Double Direction	Single Direction
Banded	No
Cage Material	Steel
Precision Class	ABEC 1 ISO P0
Component Description	Roller Assembly Plus Raceways
Other Features	Single Row
Long Description	20MM Bore 1; 21MM Bore 2; 35MM Outside Diameter; 10MM Height; Ball Bearing; Single Direction; Not Banded; Steel Cage; ABEC 1 ISO P0 Precision
Inch - Metric	Metric
Category	Thrust Ball Bearings
UNSPSC	31171507
Harmonized Tariff Code	8482.10.50.08
Noun	Bearing
Keyword String	Ball Thrust
Manufacturer URL	http://www.skf.com
Manufacturer Item Number	51104
Weight / LBS	0.095
Outside Diameter	1.378 Inch 35 Millimeter
Bore 2	0.827 Inch 21 Millimeter
Bore 1	0.787 Inch 20 Millimeter
Overall Height with Aligning Washer	0 Inch 0 Millimeter
Height	0.394 Inch 10 Millimeter
bore diameter:	20 mm
static load capacity:	29 kN
outside diameter:	35 mm



PCIF BEARING LIMITED

dynamic load capacity:	15.1 kN
overall width:	10 mm
maximum rpm:	10000 RPM
thrust bearing type:	Single-Direction
cage material:	Steel
outside diameter design:	Straight
fillet radius:	0.3 mm
separable or banded:	Separable
series:	511
precision rating:	ABEC 1 (ISO Class Normal)
d_1	35 mm
D_1	21 mm
$r_{1,2}$ min.	0.3 mm
d_a min.	29 mm
D_a max.	26 mm
r_a max.	0.3 mm
Basic dynamic load rating C	15.1 kN
Basic static load rating C_0	29 kN
Fatigue load limit P_u	1.08 kN
Minimum load factor A	0.0044
Mass bearing (including seat washer where applicable)	0.037 kg