

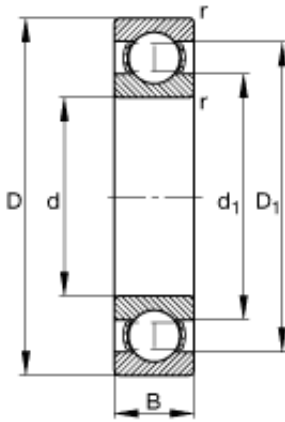

# PCIF BEARING LIMITED

## 35 mm x 72 mm x 17 mm fag 6207 bearing

Bearing No. 6207



6207 Bearing 2D drawings and 3D CAD models

Size	35x72x17 mm
Bore Diameter	35 mm
Outer Diameter	72 mm
Width	17 mm
d	35 mm
D	72 mm
B	17 mm
D <sub>1</sub>	60,7 mm
D <sub>a max</sub>	65 mm
d <sub>1</sub>	47,2 mm
d <sub>a min</sub>	42 mm
r <sub>a max</sub>	1 mm
r <sub>min</sub>	1,1 mm
m	0,291 kg / Weight
C <sub>r</sub>	27500 N / Dynamic load rating (radial)
C <sub>0r</sub>	15300 N / Static load rating (radial)
n <sub>G</sub>	13800 1/min / Limiting speed
n <sub>B</sub>	10300 1/min / Reference speed
C <sub>ur</sub>	770 N / Fatigue limit load, radial